

MODEL	SPECIFICATION		Page
TE series Tact Switch	Subminiature Tact Switch RoHS&REACH Compliant / Halogen Free	SP-001	1/8

Order Information

TE	S	1	Y	6	R	—	U
Subminiature Tact Switch TE series Terminal Type None=Thru-hole S =SMD for under Foil SM =SMD for with Cap	Circuit 0 =Pin①②vs③④ 1 =Pin①③vs②④	Push Force None =400gf/ 4.0N 6 =600gf/ 6.0N	Y=Right Angle	Package None =Tube R =Tape &	None =RoHS & Reach Compliant		U

Specifications

◆ Contact Rating24VDC,20mA; Min. 0.5W
◆ Contact Resistance100mΩ max. (after life test: 200mΩ max.)
◆ Insulation Resistance1000MΩ at 100 VDC
◆ Dielectric Strength250VAC,50Hz for the duration of 1 minute
◆ Operating Temperature-25°C to+ 85°C
◆ Mechanical Life1,000,000 operations
◆ Push Force400gf±100gf/ 4.0N ±1.0N (after life test: 200-500gf)
◆ Travel0.75±0.25
◆ Mountingon pc-board
◆ WaterproofMeet IP67

Materials:

◆ Button : Silicone, IVORY color
◆ Base :TE1/TE1Y Thermoplastic, meets UL 94-HB, Blue
TE0 Thermoplastic, meets UL 94-HB, Red
TES0/TESM0 Thermoplastic, meets UL 94V-0, White
TES1/TESM1 Thermoplastic, meets UL 94V-0, Black
◆ Contact Disc : Stainless steel , Silver Plated over Nickel barrier
◆ Terminal Contact : Brass, 1u" Gold-plated
◆ Terminal : Brass, Tin-plated
◆ Bracket : Brass, Tin-plated
◆ Cap : Thermoplastic, PC UL 94-V2

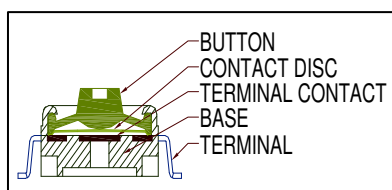

MODEL	SPECIFICATION Subminiature Tact Switch RoHS&REACH Compliant / Halogen Free	Page	2/8
TE series Tact Switch		SP-002	

TE1

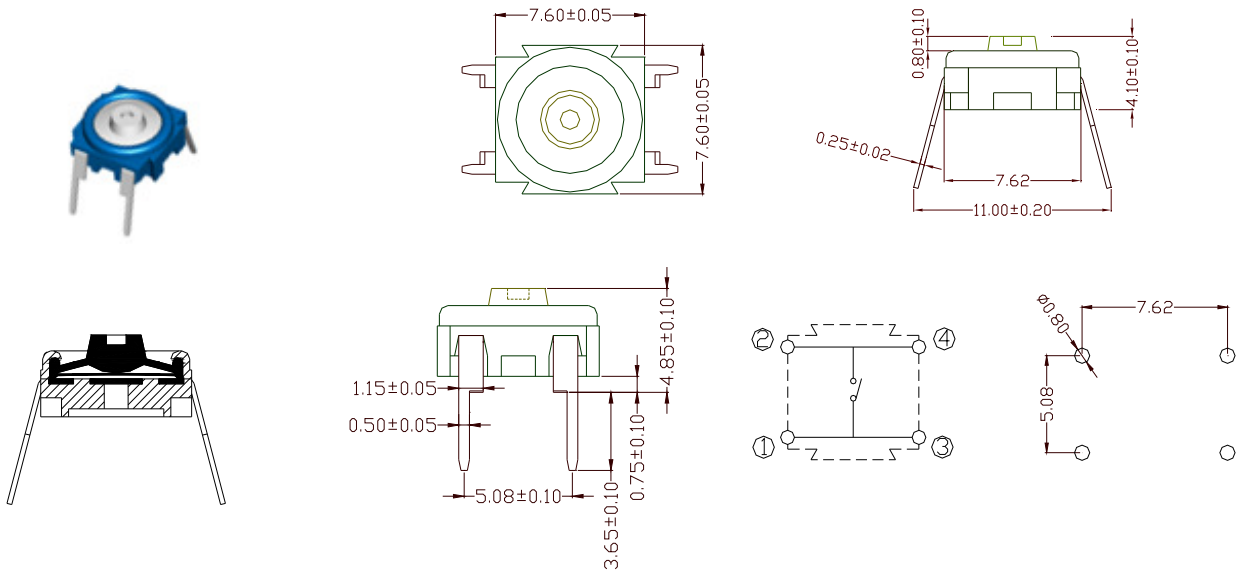

TES1 (SMD for Under Foil)

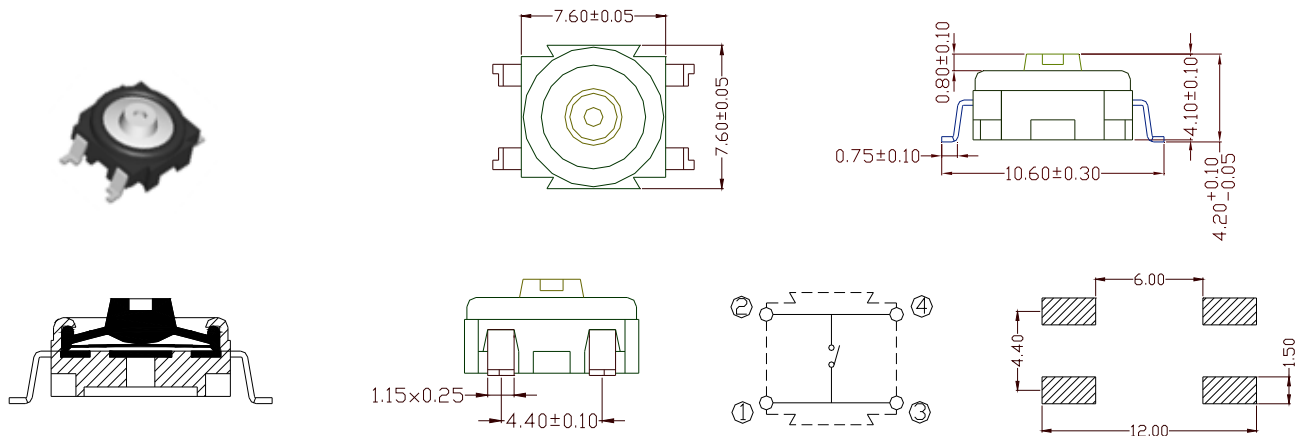

TESM1 (SMD for with Cap)

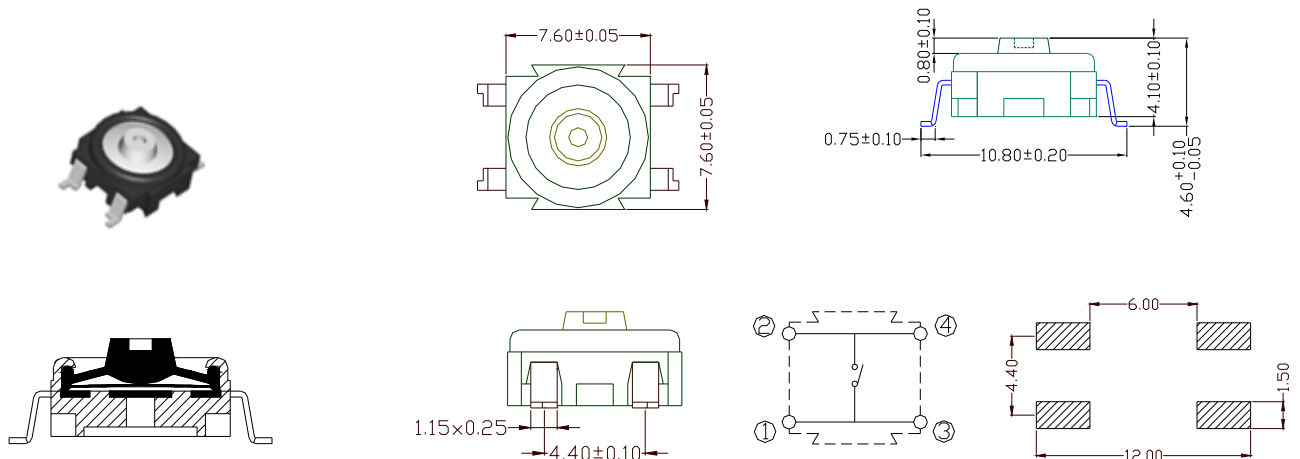

MODEL	SPECIFICATION		Page
TE series Tact Switch	Subminiature Tact Switch RoHS&REACH Compliant / Halogen Free	SP-003	3/8

TE0

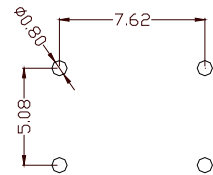
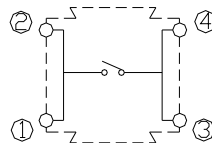
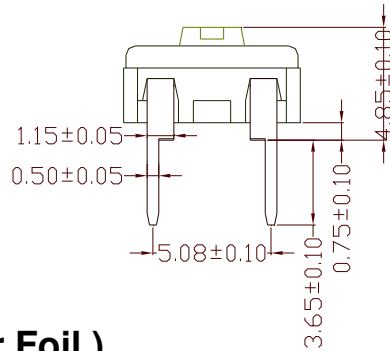
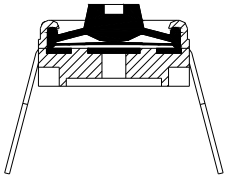
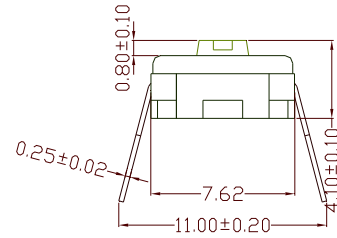
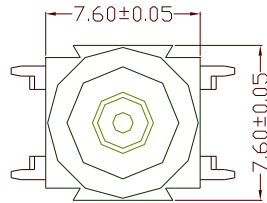

TES0 (SMD for Under Foil)

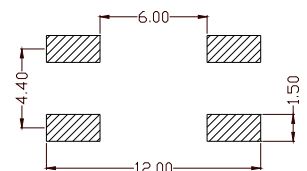
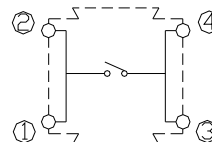
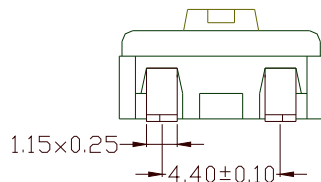
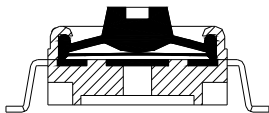
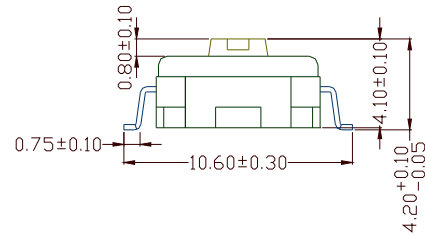
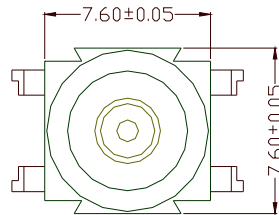

TESM0 (SMD for with Cap)

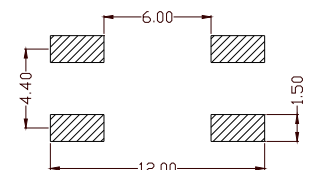
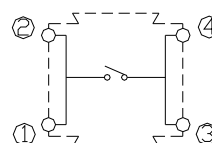
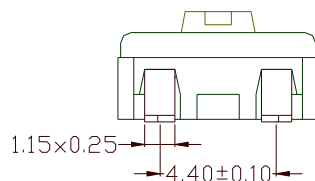
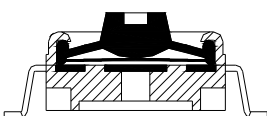
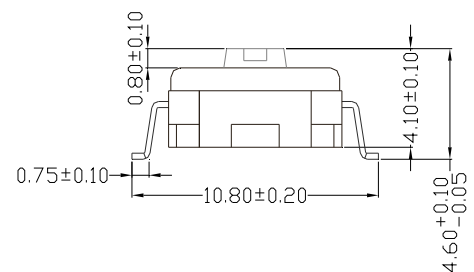
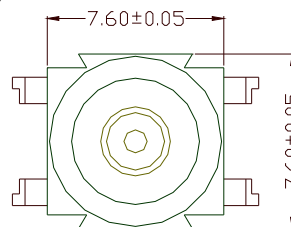

MODEL	SPECIFICATION		Page
TE series Tact Switch	Subminiature Tact Switch RoHS&REACH Compliant / Halogen Free	SP-004	4/8

TE1Y

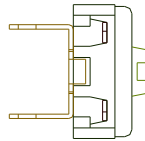
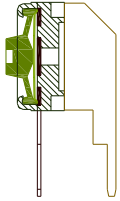
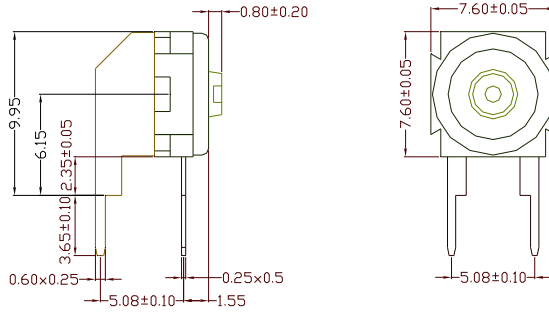
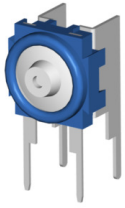

CIRCUIT DIAGRAM

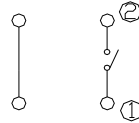

DRILLING PLAN

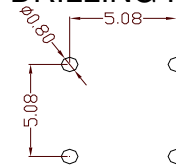

CAP

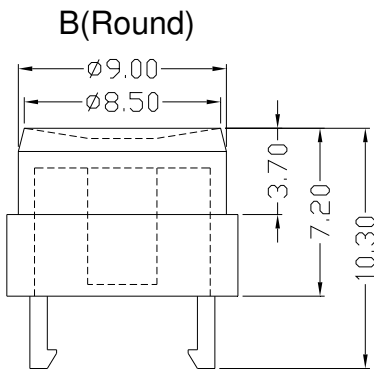
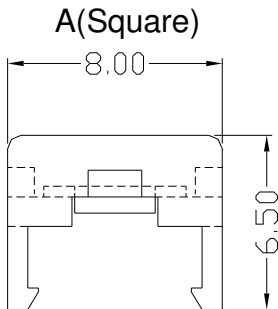

Cap Order Information

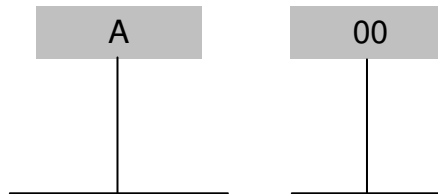

- | | |
|-----------------------|-----------------------|
| A: Square | 00: Blue |
| B: Round | 02: Green |
| C: Square type | 03: Light Grey |
| Texture surface | 04: Yellow |
| | 05: Dark Grey |
| | 06: White |
| | 08: Red |
| | 09: Black |

Note:

- All caps are not allowed to pass through the soldering process.
- All caps should be assembled after all soldering processes are finished.

Switch with Cap

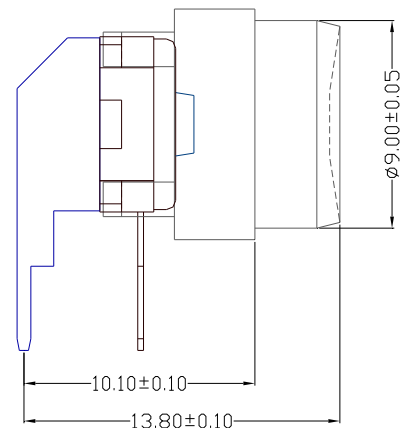
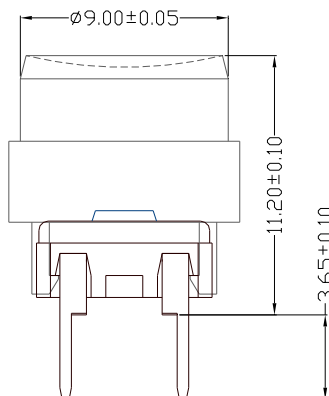

MODEL	SPECIFICATION Subminiature Tact Switch RoHS&REACH Compliant / Halogen Free	Page
TE series Tact Switch		SP-005 5/8

TE Typical system assembly with Plunger under overlay

Solder terminal for PCB.

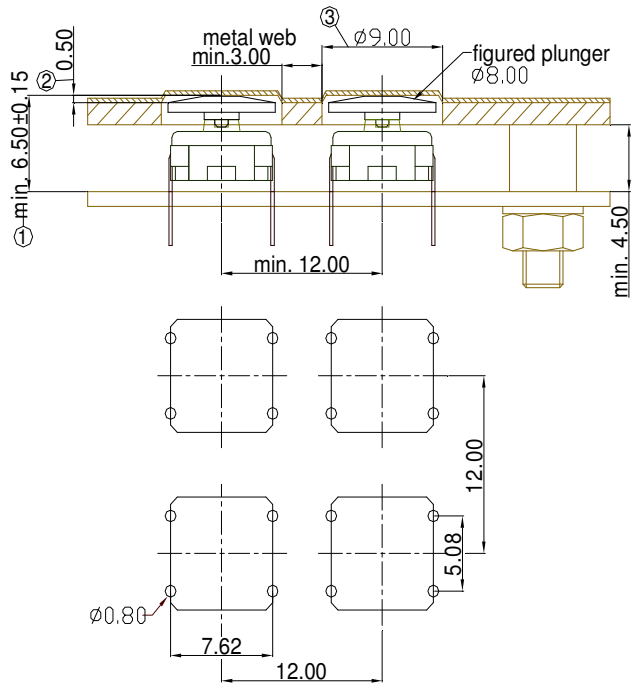

SMD gullwing terminal

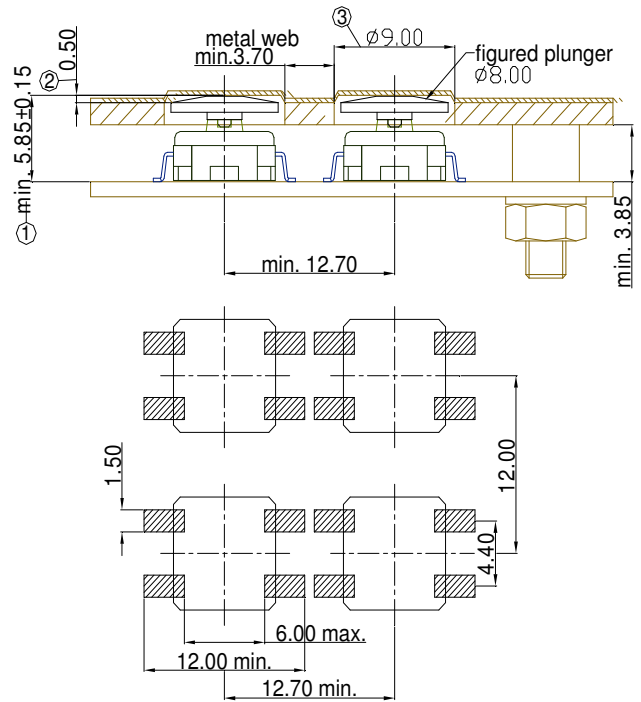

Explanation:

- 1 Overall height = TE + plunger
- 2 Recommended area embossing 0.35 mm at glue spacer thickness of 0.15 mm
- 3 Front panel cut out = plunger diameter + 1 mm

MODEL	SPECIFICATION		Page
TE series Tact Switch	Subminiature Tact Switch RoHS&REACH Compliant / Halogen Free	SP-006	6/8

Soldering Information

◆ Hand Soldering

Soldering iron of 30W or under at 350°C for 3 sec max or at 270°C for 5 sec max.

◆ Reflow Soldering

Allow 1-time reflow process only.

◆ Wave Soldering

For lead free wave solder simulation of typical components, the solder bath temperature shall be maintained at 270°C max./ 5~10 seconds.

※ After reflow soldering, the white button will turn yellow. This is due to the characteristics of plastic, the switch's function is not affected.

Note:

1. All caps are not allowed to pass through the soldering process.
2. All caps should be assembled after all soldering processes are finished.

Recommended Wave Soldering Profiles

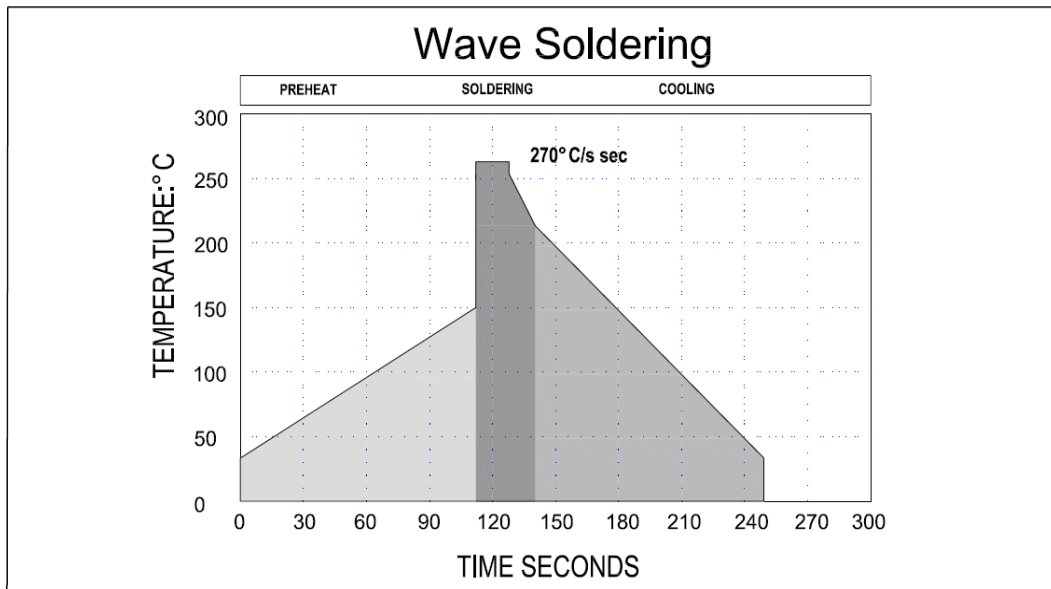

Maximum dwell time in the solder wave (270°C) shall not exceed 10 seconds.

MODEL	SPECIFICATION Subminiature Tact Switch RoHS&REACH Compliant / Halogen Free	SP-007	Page
TE series Tact Switch			7/8

Classification Reflow Profiles

Profile Feature	Pb-Free Assembly
Preheat / Soak	
Temperature Min (T_{Smin})	150°C
Temperature Max (T_{Smax})	200°C
Time(ts) from (T_{Smin} to T_{Smax})	60 ~120 seconds
Ramp-up Rate (T_L to T_p)	3°C/second max
Liquidous temperature (T_L)	217°C
Time (t_L) maintained above to T_L	60 ~ 150 seconds
Peak package body temperature (T_p)	For users T_p must not exceed the Classification temp:260°C (Package Thickness:>2.5mm) For suppliers T_p must equal or exceed the Classification temp:250°C (Package Thickness:>2.5mm)
Time (t_p) within 5°C of specified classification Temperature (T_c)	30 seconds
Ramp-Down Rate (T_p to T_L)	6°C/second max
Time 25°C to Peak Temperature	8 minutes max
* Tolerance for peak profile temperature(T_p) is defined as a supplier minimum and a user maximum	

Note 1: All temperatures refer to topside of the package, measured on the package body surface.

Note 2: Time within 5 °C of actual peak temperature (t_p) specified for the reflow profiles is a “supplier” minimum and “user” maximum.

Sources: IPC/JEDEC J-STD-020 D.1

Recommended Reflow Soldering Conditions

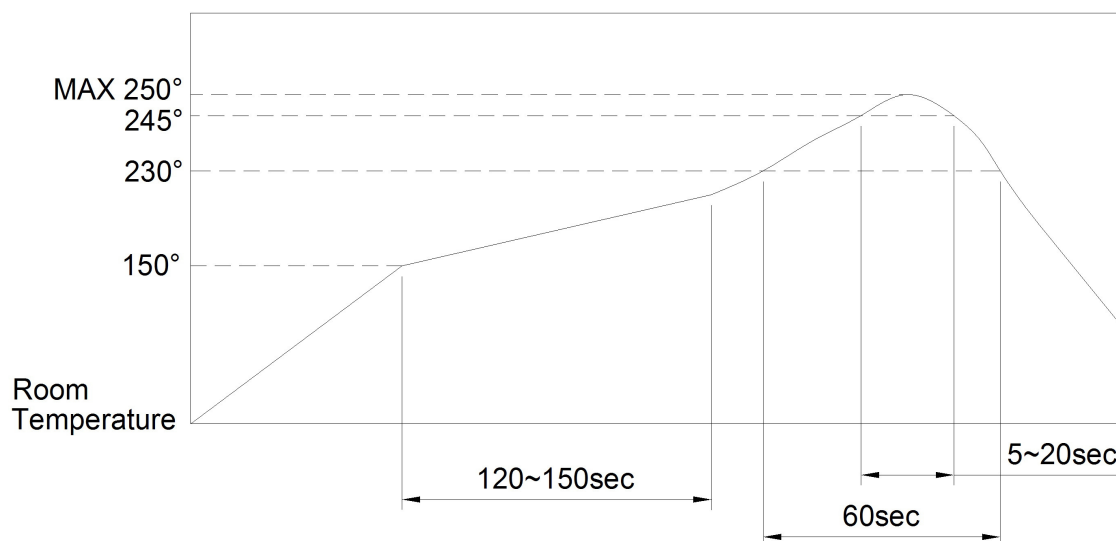

MODEL	SPECIFICATION Subminiature Tact Switch RoHS&REACH Compliant / Halogen Free	SP-008	Page
TE series Tact Switch			8/8

Package:

P/N	Quantity per Tube
TE0	50
TES0/TESM0	50
TE1	50
TES1/TESM1	50
TE1Y	50

P/N	Quantity per Reel
TES0-R/TESM0-R	1100
TES1-R/TESM1-R	1100

P/N	Quantity per Bag
CAP	1000

TUBE (Tube = 400mm L)

Thru-hole

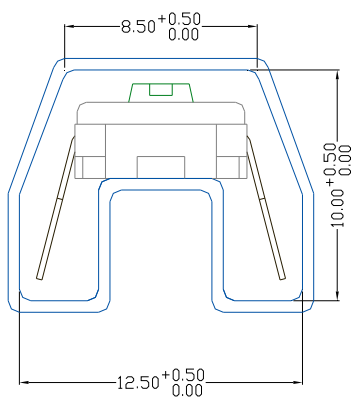

SMD

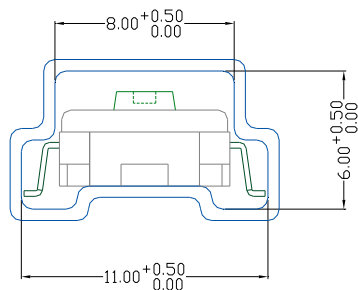

Right Angle

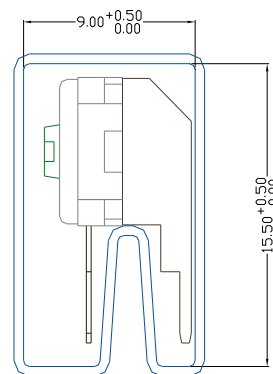

Tape & Reel Package

◆ TES0/TESM0/TES1/TESM1

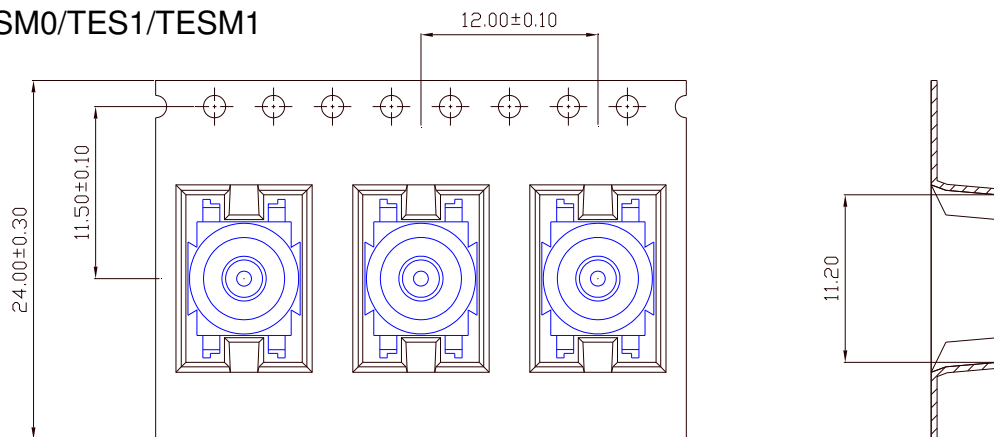

Box Dimension:

- ◆ Tube 57.0cm x 13.0cm x 12.5cm
- ◆ Reel 34.0cm x 13.0cm x 35.5cm

Carton Dimension:

- ◆ Tube
2 Boxes..... 58.5cm x 29.0cm x 15.0cm
4 Boxes..... 58.5cm x 28.0cm x 27.0cm
- ◆ Reel
2 Boxes 36.0cm x 27.5cm x 37.0cm